

TYPICAL WINDOW ELEVATION

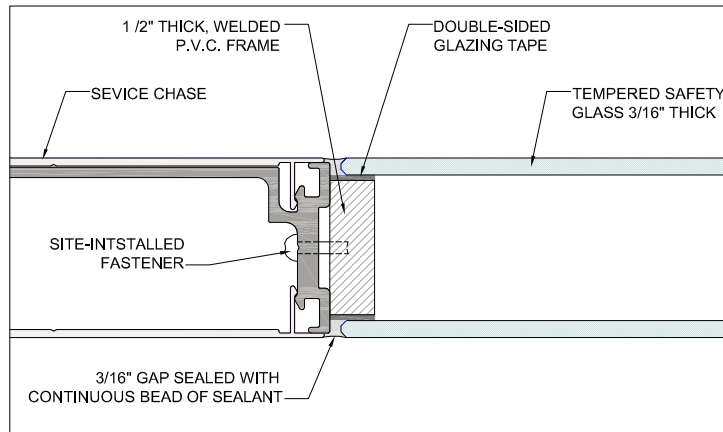

PARTIAL SECTION A-A

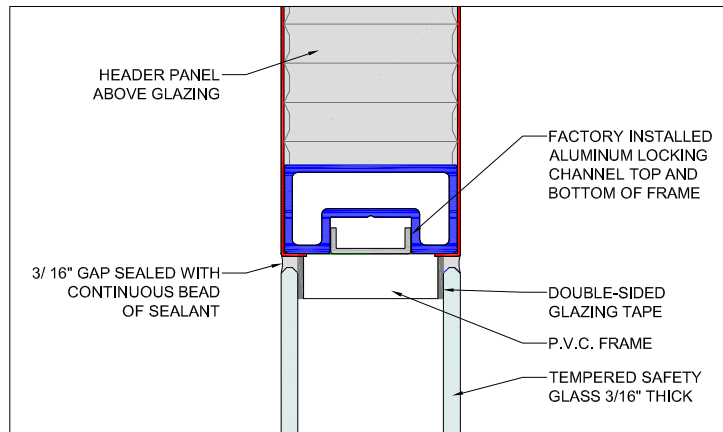

PARTIAL SECTION B-B

NOTES:

1. WINDOW FRAMES ARE CONSTRUCTED OF 1/2" THICK WELDED P.V.C. (COLOUR: SUPER-WHITE), c/w 3/16" THICK TEMPERED SAFETY GLASS BOTH SIDES
2. STANDARD GLAZING UNIT SIZE: 46.5" WIDE x 36" HIGH x 2" THICK
3. OPTIONAL TINTED FILM AVAILABLE
 - NO TINT
 - YELLOW
 - RED
 (CHECK WITH FACTORY FOR E.M.S. TRANSMISSION WAVELENGTH)

REV	DESCRIPTION	DATE	DRAWN
7	GENERAL REVIEW	SEPT 06	P.F.
6	GENERAL REVIEW	SEPT 05	M.L.
5	GENERAL REVIEW	27 JUL 05	P.F.
4	GENERAL REVIEW	JULY 2005	M.L.
3	NEW WALL PANEL DETAILS & LAYOUT	20 NOV 03	M.L.
2	COLOUR PLOT MODIFIED	17 FEB 03	DLMM
1	ORIGINAL ISSUE	06 FEB 03	DLMM



INTRODUCTION TO MODULAR CLEANROOMS AND CONTAINMENT FACILITY SYSTEMS

PRE-FABRICATED FLUSH-TYPE GLAZING UNITS

Drawn By	P.F./M.L.	Checked By	P.F.	Scale	AS NOTED	Date	20 NOV 03
Issue	---	Job Number	---	Drawing Number	---		
Issue	---	Job Number	---	Drawing Number	---		

UNLESS OTHERWISE NOTED, THIS DRAWING REMAINS THE PROPERTY OF MICROZONE CORPORATION. IT SHALL NOT BE REPRODUCED OR USED FOR MANUFACTURE, SECTION OR CONSTRUCTION WITHOUT THE EXPRESSED WRITTEN AUTHORIZATION BY THE OWNER OR RECIPIENT. BY ACCEPTING THIS DRAWING, ASSUMES THE CUSTOMER THEREOF AND WAIVES THE ABOVE TERMS. AGREES NOT TO ALLOW ITS USE BY UNAUTHORIZED PERSONS, WITHOUT INCURRING LIABILITY FOR PENALTIES IMPOSED BY LAW.